**Port Stephens
Local Traffic Committee Minutes**

**Meeting held on
Tuesday 2nd February, 2021 at 9.30am**

Present:

Mayor Ryan Palmer, Cr Steve Tucker, Stephen Moore representing Kate Washington MP, Senior Constable Margy Bernard - NSW Police, John Carey – Transport for NSW, John Meldrum – Hunter Valley Buses, Anthony Biscan – Port Stephens Coaches, Mal Britt – Busways, Andrew Behrens, Graham Orr, Bridget Jenkins, Joe Gleeson (Chairperson) – Port Stephens Council

A. Listed matters

- | | |
|-----------------|--|
| 01_02/21 | Victoria Parade, Nelson Bay - Request for signage to prevent illegal camping at Fly Point |
| 02_02/21 | Peppertree Road, Medowie – Request for installation of a bus zone |
| 03_02/21 | Victoria Parade, Nelson Bay – Request to review 'No Stopping' |
| 04_02/21 | Kerrigan Street, Nelson Bay – Complaint regarding the Kerrigan/Trevally intersection |
| 05_02/21 | Church Street, Nelson Bay – Request to extend 'No Stopping' |
| 06_02/21 | Soldiers Point Road, Soldiers Point – Request for a new taxi rank |
| 07_02/21 | Magnus Street, Nelson Bay – Request for 'No Parking' at Laidler Walk path access point |
| 08_02/21 | Church Street, Nelson Bay – Request to relocate 'No Stopping' at No.10 |

A. Listed matters

Item: 01_02/21

Victoria Parade, Nelson Bay – Request for signage to prevent illegal camping at Fly Point

Requested by: PSC Rangers

File:

Background:

Council often receives requests to move-on illegal campers at Fly Point, however there are limited options for rangers to prevent people parking overnight.

Signs such as 'Restricted Parking Area - No Parking 11pm to 5am' would discourage the majority of campers and would give Police and rangers the ability to issue infringement notices.

Comment:

Inspection Committee members noted that a restricted parking area would be relatively simple to implement.

Legislation, Standards, Guidelines and Delegation:

NSW Road Rules – Rule 168-1 – Restricted parking areas

RMS signs database – R5-541, R5-542

Traffic control devices installed under Part 5.3 Div. 2 Road Transport Act 2013

Discussion:

Committee members requested that reminder signs be included to ensure that people are aware of the restrictions. It was also recommended that Council liaise with the dive operators to ensure that the proposal does not impact on diving activities at Fly Point.

Committee's Recommendation:

Install 'Restricted parking area' signs at the entry and the exit to the Fly Point one-way area of Victoria Parade, Nelson Bay, as shown on the attached sketch, Annexure A.

Support for the recommendation:

| | | |
|---|-------------------|---|
| 1 | Unanimous | ✓ |
| 2 | Majority | |
| 3 | Split Vote | |
| 4 | Minority Support | |
| 5 | Unanimous decline | |

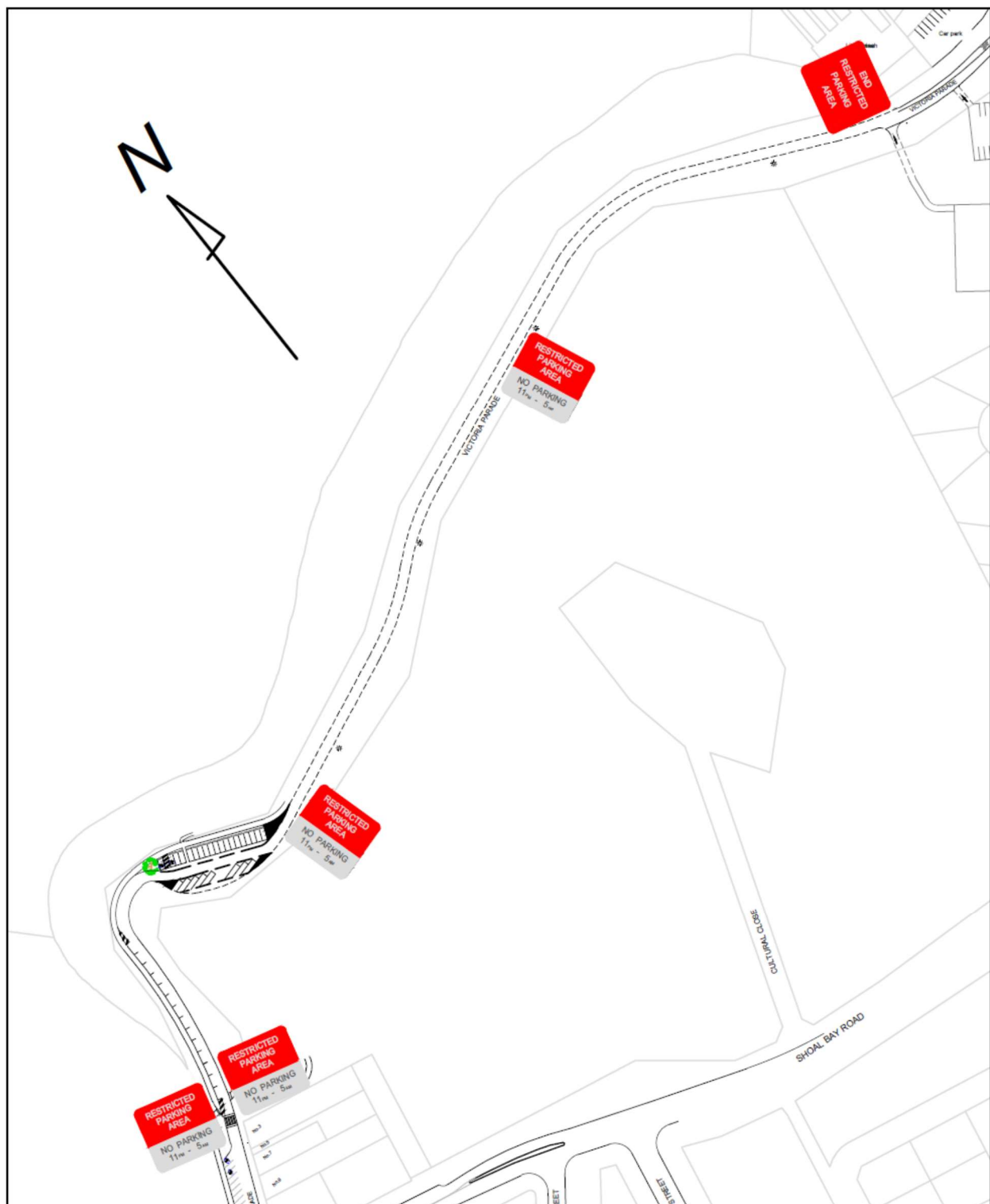

Legend

RESTRICTED
PARKING
AREA
NO PARKING
11pm - 5am

END
RESTRICTED
PARKING
AREA

Item: 02_02/21

Peppertree Road, Medowie – Request for installation of a bus zone

Requested by: Hunter Valley Buses

File:

Background:

HVB states: “we would need 40m zoned allowing buses to draw in and out if vehicles were parked at either end. Starting from where the white path starts after the Coles delivery driveway.

Not sure why we ever lost it to be honest because we have a school bus through there of an afternoon and eventually that road will go through making it the ideal spot for a bus stop in between the two shops and McDonalds.”

Comment:

Inspection Committee members agreed with the request, noting that interaction may result between a bus stop and McDonalds, requiring some type of pedestrian facility in future

Legislation, Standards, Guidelines and Delegation:

NSW Road Rules – Rule 183 – Stopping in a bus zone

RMS signs database – R5-20

Traffic control devices installed under Part 5.3 Div. 2 Road Transport Act 2013

Committee’s Recommendation:

Install a bus zone in Peppertree Road, Medowie, as shown on the attached sketch, Annexure A.

Support for the recommendation:

| | | |
|---|-------------------|---|
| 1 | Unanimous | ✓ |
| 2 | Majority | |
| 3 | Split Vote | |
| 4 | Minority Support | |
| 5 | Unanimous decline | |



Legend

| | | |
|------|---|----------------------|
| N St | = | No Stopping |
| BZ | = | Bus Zone |
| UNR | = | Unrestricted parking |

Item: 03_02/21

Victoria Parade, Nelson Bay – Request to review 'No Stopping'

Requested by: A resident

File:

Background:

The resident states: “No-Stopping zone is completely across the front of our property. This means we have lost legal egress via vehicles to our property to drop-off, pick-up, load/unload for unknown reasons.

There is a garage exit within this zone which is not accessible to any car since council replaced the footpath with a higher gradient. This means that residents or approved visitors can now be fined for stopping in front of their own house to unload or pick up. Elderly owners, with mobility issues are now unable to be dropped off legally from cars outside the property. This is clearly unacceptable.”

Comment:

Inspection Committee members noted that 'No Parking' would allow for pick-up and drop-off although it only allows the vehicle to stay for 2 minutes and for the driver to stay with the vehicle.

Legislation, Standards, Guidelines and Delegation:

NSW Road Rules – Rule 168 – No parking signs

RMS signs database – R5-40

Traffic control devices installed under Part 5.3 Div. 2 Road Transport Act 2013

Committee’s Recommendation:

Change existing 'No Stopping' to 'No Parking' at No. 45-47 Victoria Parade, Nelson Bay, as shown on the attached sketch, Annexure A.

Support for the recommendation:

| | | |
|---|-------------------|---|
| 1 | Unanimous | ✓ |
| 2 | Majority | |
| 3 | Split Vote | |
| 4 | Minority Support | |
| 5 | Unanimous decline | |

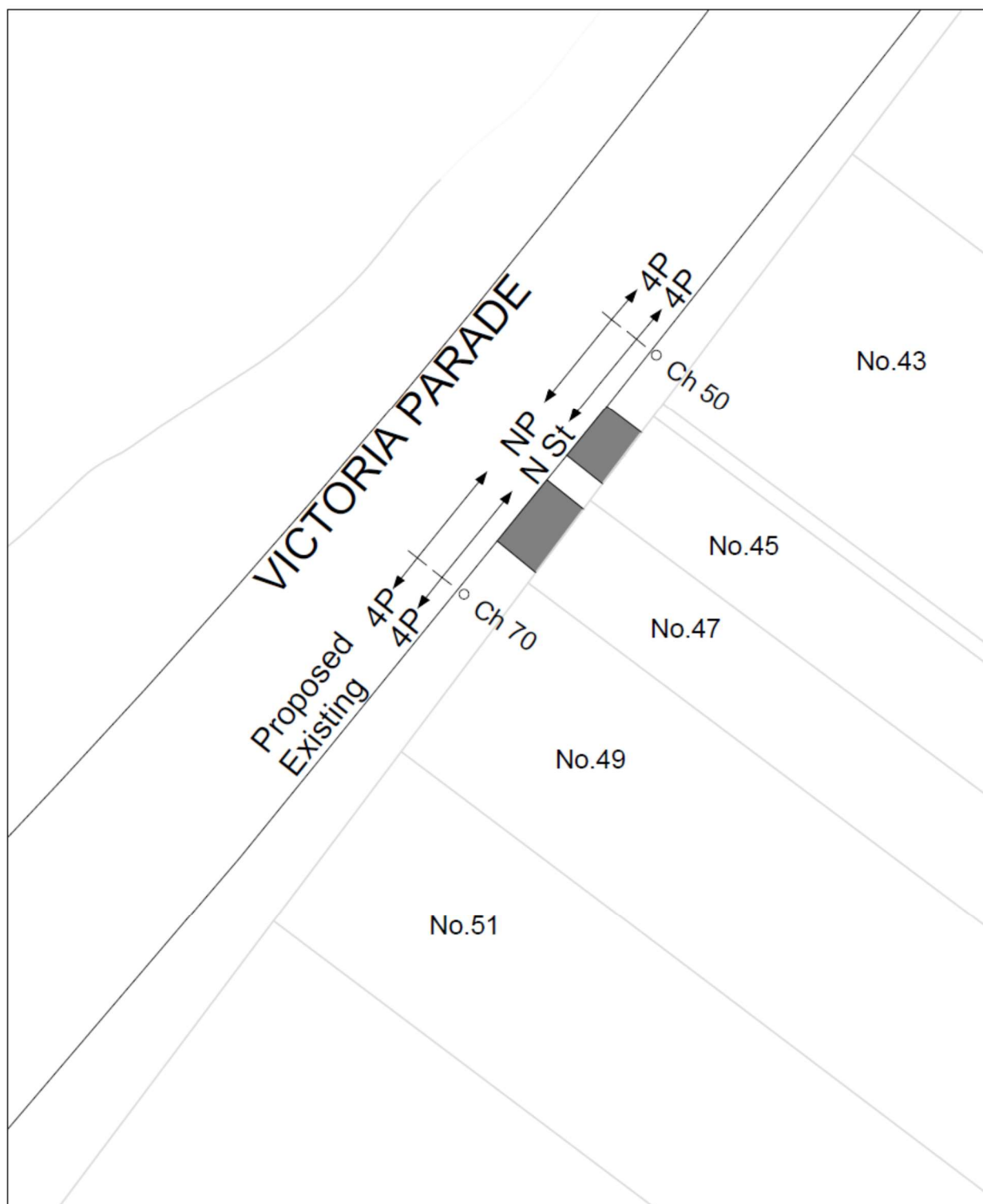

Legend

| | | |
|------|---|---|
| 4P | = | 4 Hour parking - 8.30am - 4.30pm Sat, Sun & Public Holidays |
| N St | = | No Stopping |
| NP | = | No Parking |

Item: 04_02/21

Kerrigan Street, Nelson Bay – Complaint regarding the Kerrigan/Trevally intersection

Requested by: A resident
File: 283298-2020
Background:

The resident states: “Over the last couple of days I have noticed some drivers ignoring the broken white lines, on the road, at the Tomaree local hospital T Junction. They come down the hill, and just keep on going , when someone is making a legitimate right hand turn. Please be aware of this - The T Junction in question is : Trevally Street/Kerrigan Street, Nelson Bay.”

Comment:

Inspection Committee members noted that the site is unlikely to meet the requirements for 'Stop' control. A median island would allow for duplication of signs in the middle of the road and would be an improvement but would impact ability of residents to access adjacent driveways. It was noted that the changed priorities have been in place for a long time and that advanced warning signs may assist.

Legislation, Standards, Guidelines and Delegation:

NSW Road Rules – Rule 69 – Giving way at a give way sign or give way line at an intersection (except a roundabout)
RMS signs database – R1-2
Traffic control devices installed under Part 5.3 Div. 2 Road Transport Act 2013

Discussion:

Local Traffic Committee members noted that the changed priorities of the intersection had substantially reduced the volume of traffic using Kerrigan Street, which was the original intention.

Committee members gave conditional support to a suggestion to install ‘Give Way Ahead’ pavement markings, in addition to advanced warning signs, subject to a determination that such markings are in accordance with the Delineation Manual – ‘Pavement Markings’. Subsequent investigations have found that the ‘Give Way Ahead’ advanced pavement warnings are not supported by the Delineation Manual.

It was also recommended that the advanced warning signs be ‘B’ size and that they be positioned so as to have the best visual impact on approaching drivers.

Committee’s Recommendation:

Install 'B' size, advanced, Give Way warning signs (W3-2) in Kerrigan Street, Nelson Bay, on approaches to the Trevally Street intersection, as shown on the attached sketch, Annexure A.

Support for the recommendation:

| | | |
|---|-------------------|---|
| 1 | Unanimous | ✓ |
| 2 | Majority | |
| 3 | Split Vote | |
| 4 | Minority Support | |
| 5 | Unanimous decline | |



Legend

Item: 05_02/21

Church Street, Nelson Bay – Request to extend 'No Stopping'

Requested by: A resident
File: 283861-2021
Background:

The resident states: “On the intersection of Tomaree Street and Church Street, as a car trying to cross the intersection coming from the Nelson Street and Church Street intersecting portion of Tomaree Street, you are often left with no view at all of oncoming traffic, as the slight dip, paired with the cars parked on either side of Church Street, means all smaller style cars (such as sedans) have zero vision of the traffic flow. I am requesting the 'no stopping' signs on church street (heading in the direction of government road) to be pushed back to improve visibility of the road.”

Comment:

Inspection Committee members agree that safety could be improved by increasing 'No Stopping' distances as requested.

Legislation, Standards, Guidelines and Delegation:

NSW Road Rules – Rule 167 – No stopping signs
RMS signs database – R5-400
Traffic control devices installed under Part 5.3 Div. 2 Road Transport Act 2013

Committee's Recommendation:

Relocate the 'No Stopping' restrictions either side of Tomaree Street intersection, on Church Street, Nelson Bay, as shown on the attached sketch, Annexure A.

Support for the recommendation:

| | | |
|---|-------------------|---|
| 1 | Unanimous | ✓ |
| 2 | Majority | |
| 3 | Split Vote | |
| 4 | Minority Support | |
| 5 | Unanimous decline | |

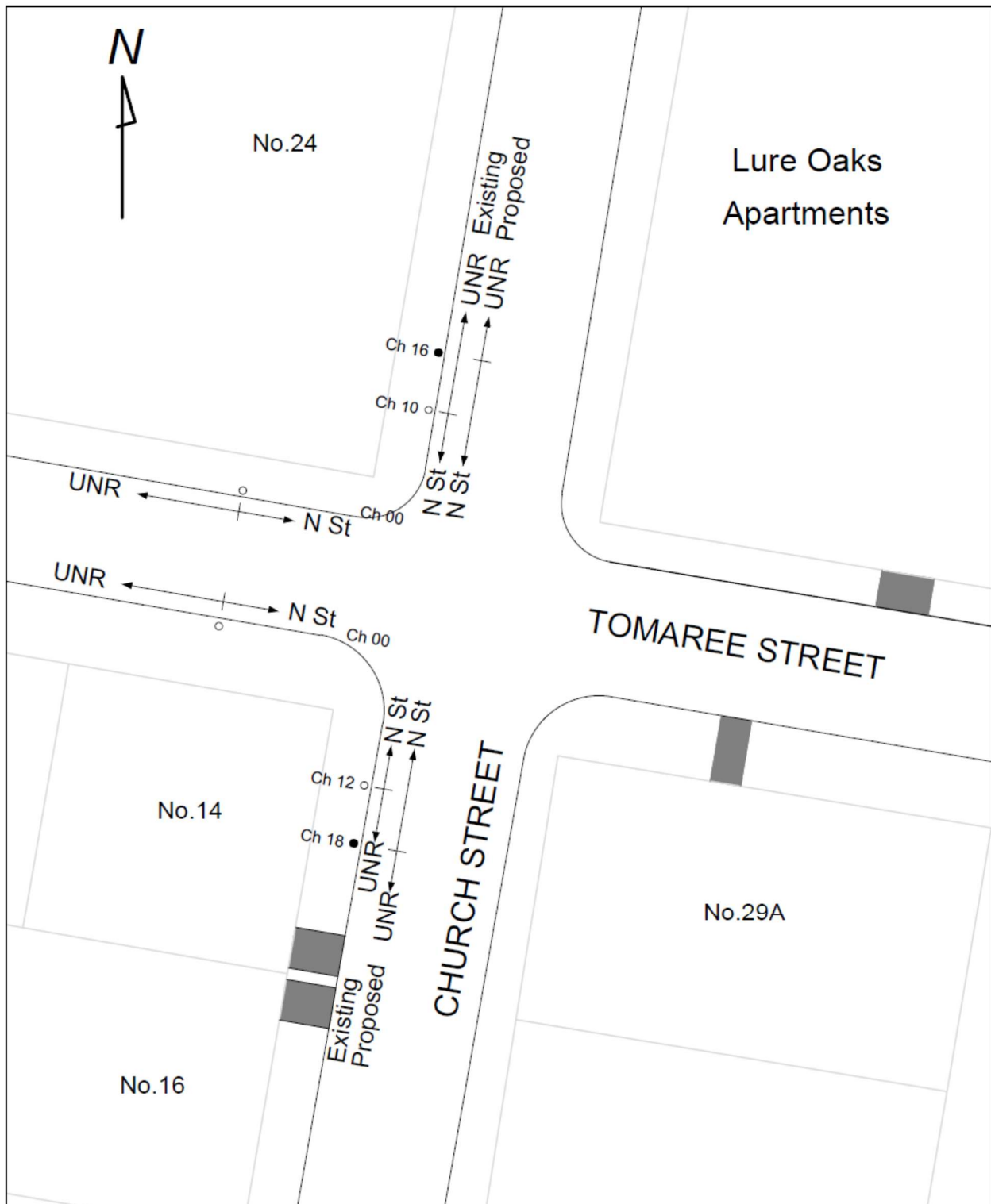

Legend

N St = No Stopping
UNR = Unrestricted parking

Item: 06_02/21

Soldiers Point Road, Soldiers Point – Request for a new taxi rank

Requested by: Combined Hunter Hire Cars

File: 284185-2021

Background:

Nelson Bay Taxis have requested to set up a taxi rank near to Soldiers Point Bowling Club and Bannisters Restaurant.

They state: “With the number of jobs we are receiving from the bowling club, Bannisters and Soldiers Point Marina (The Point & The Deck Restaurants) on the increase, it makes sense to have some cars on standby in the area instead of travelling from Salamander Shopping Centre.”

Comment:

Inspection Committee members have no objection to providing a taxi zone on the Bowling Club side of the road adjacent to the Bowling Club entry.

Legislation, Standards, Guidelines and Delegation:

NSW Road Rules – Rule 182 – Stopping in a taxi zone

RMS signs database – R5-21

Traffic control devices installed under Part 5.3 Div. 2 Road Transport Act 2013

Committee’s Recommendation:

Install a Taxi zone on the western side of Soldiers Point Road, at the Soldiers Point Bowling Club, as shown on the attached sketch, Annexure A.

Discussion:

Support for the recommendation:

| | | |
|---|-------------------|---|
| 1 | Unanimous | ✓ |
| 2 | Majority | |
| 3 | Split Vote | |
| 4 | Minority Support | |
| 5 | Unanimous decline | |

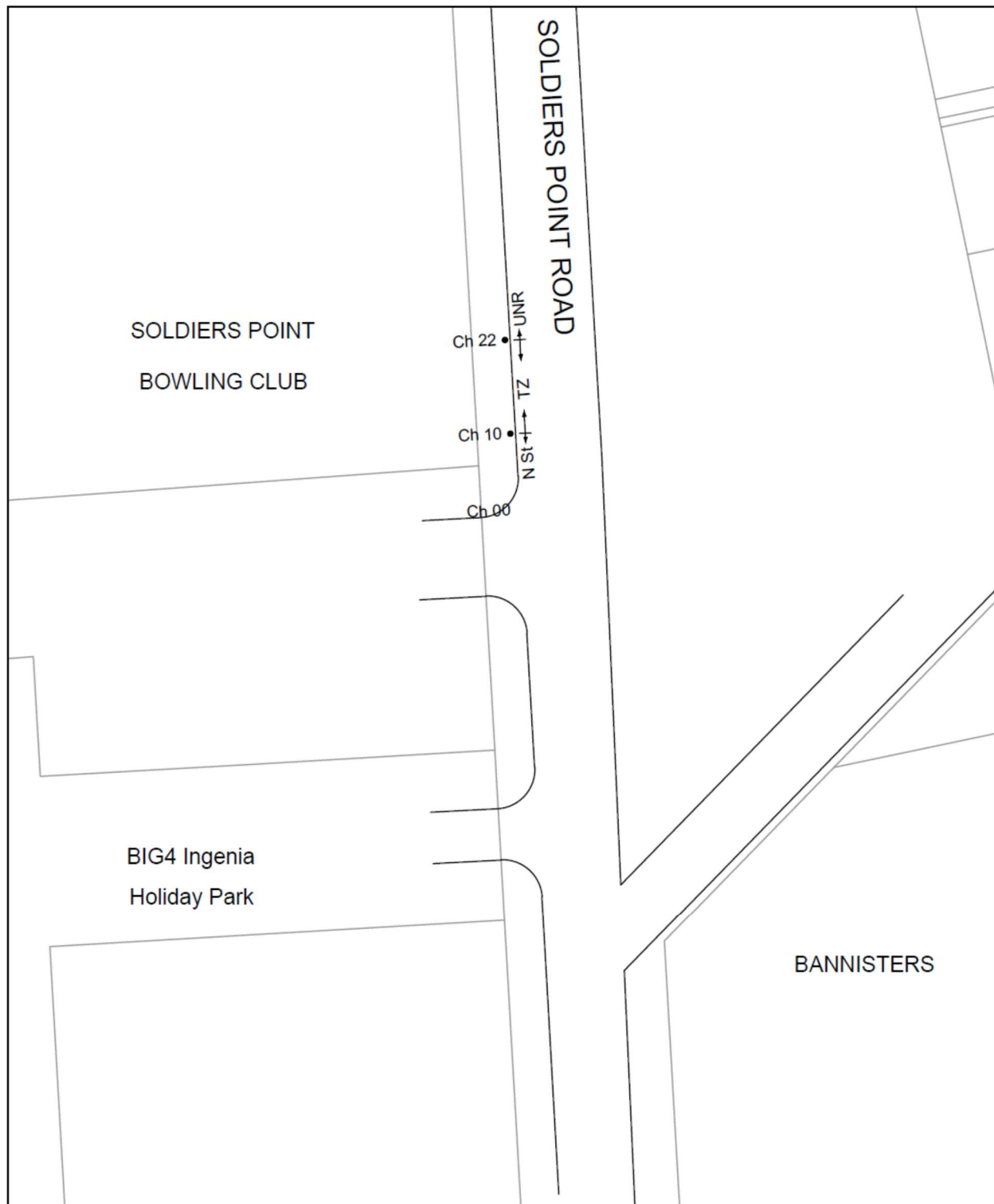

Legend

| | | |
|------|---|----------------------|
| N St | = | No Stopping |
| TZ | = | Taxi zone |
| UNR | = | Unrestricted parking |

Item: 07_02/21

Magnus Street, Nelson Bay – Request for 'No Parking' at Laidler Walk path access point

Requested by: A resident
File: 284172-2021
Background:

The resident states: “I'm writing to suggest that there should be no parking in the vicinity of the ladlers pathway in Magnus Street. This is the only access for people with disabilities, people with prams and children with bikes to go down to Victoria Parade and there are always people parked across the access to the beginning of the pathway. It is a dangerous place to cross at the best of times but with no visibility at all make it very difficult.”

Comment:

Inspection Committee members agreed that preventing vehicles being parked across the kerb ramps would improve access and safety.

Legislation, Standards, Guidelines and Delegation:

NSW Road Rules – Rule 167 – No stopping signs
RMS signs database – R5-400
Traffic control devices installed under Part 5.3 Div. 2 Road Transport Act 2013

Committee's Recommendation:

Install 'No Stopping' adjacent to the Laidler Walk pathway, on Magnus Street, Nelson Bay, as shown on the attached sketch, Annexure A.

Support for the recommendation:

| | | |
|---|-------------------|---|
| 1 | Unanimous | ✓ |
| 2 | Majority | |
| 3 | Split Vote | |
| 4 | Minority Support | |
| 5 | Unanimous decline | |

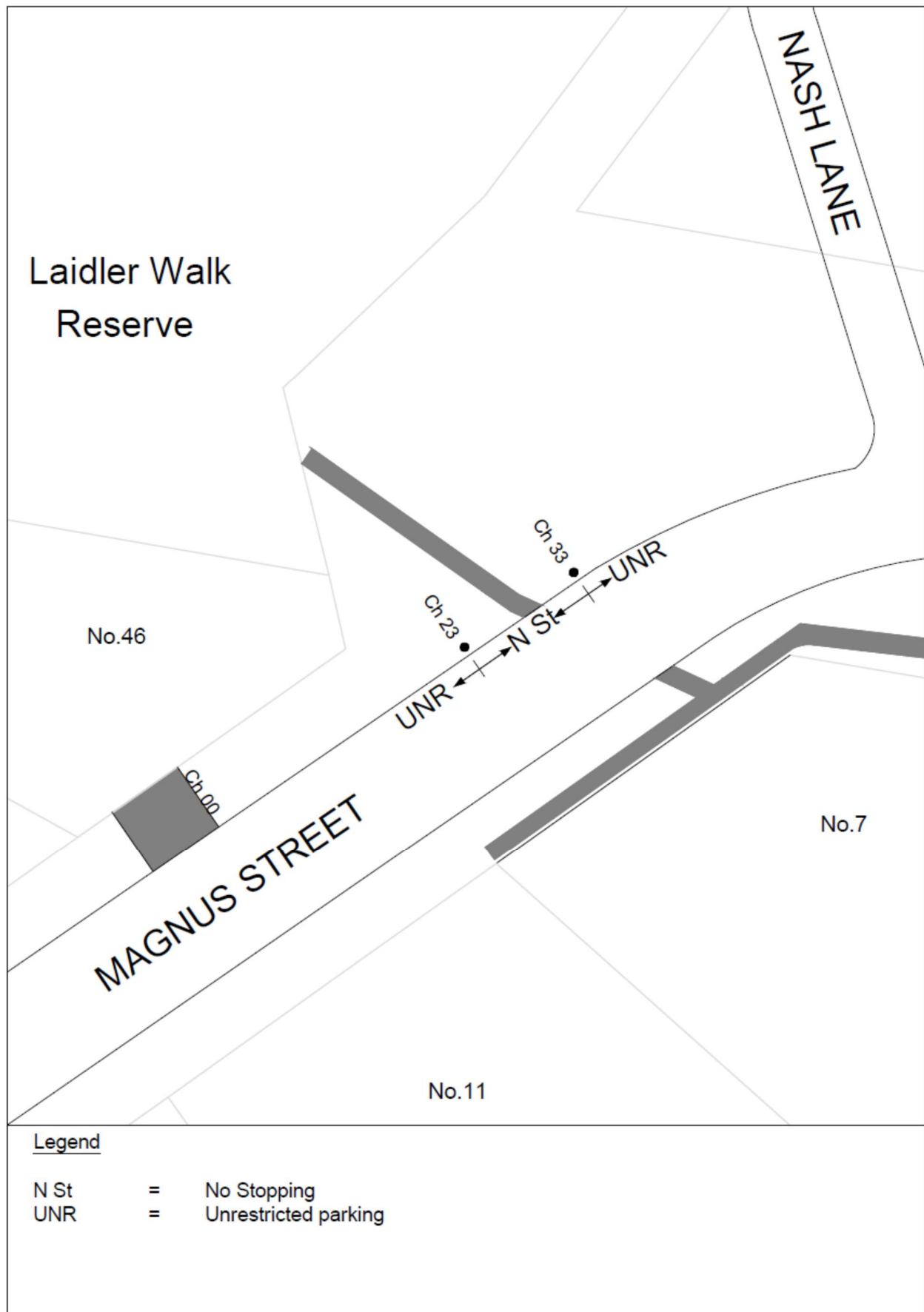

Item: 08_02/21

Church Street, Nelson Bay – Request to relocate 'No Stopping' at No.10

Requested by: A resident
File: 284147-2021
Background:

The resident contacted Council to request relocation of 'No Stopping' from adjacent to her driveway, a further 5-6m up the hill in order to improve safety when exiting the driveway.

Comment:

Inspection Committee members noted that it is difficult to see oncoming traffic when vehicles are parked right to the driveway edge and supported efforts to improve safety for the resident.

Legislation, Standards, Guidelines and Delegation:

NSW Road Rules – Rule 167 – No stopping signs
RMS signs database – R5-400
Traffic control devices installed under Part 5.3 Div. 2 Road Transport Act 2013

Committee's Recommendation:

Relocate 'No Stopping' sign 6m to the South on Church Street, Nelson Bay, as shown on the attached sketch, Annexure A.

Support for the recommendation:

| | | |
|---|-------------------|---|
| 1 | Unanimous | ✓ |
| 2 | Majority | |
| 3 | Split Vote | |
| 4 | Minority Support | |
| 5 | Unanimous decline | |

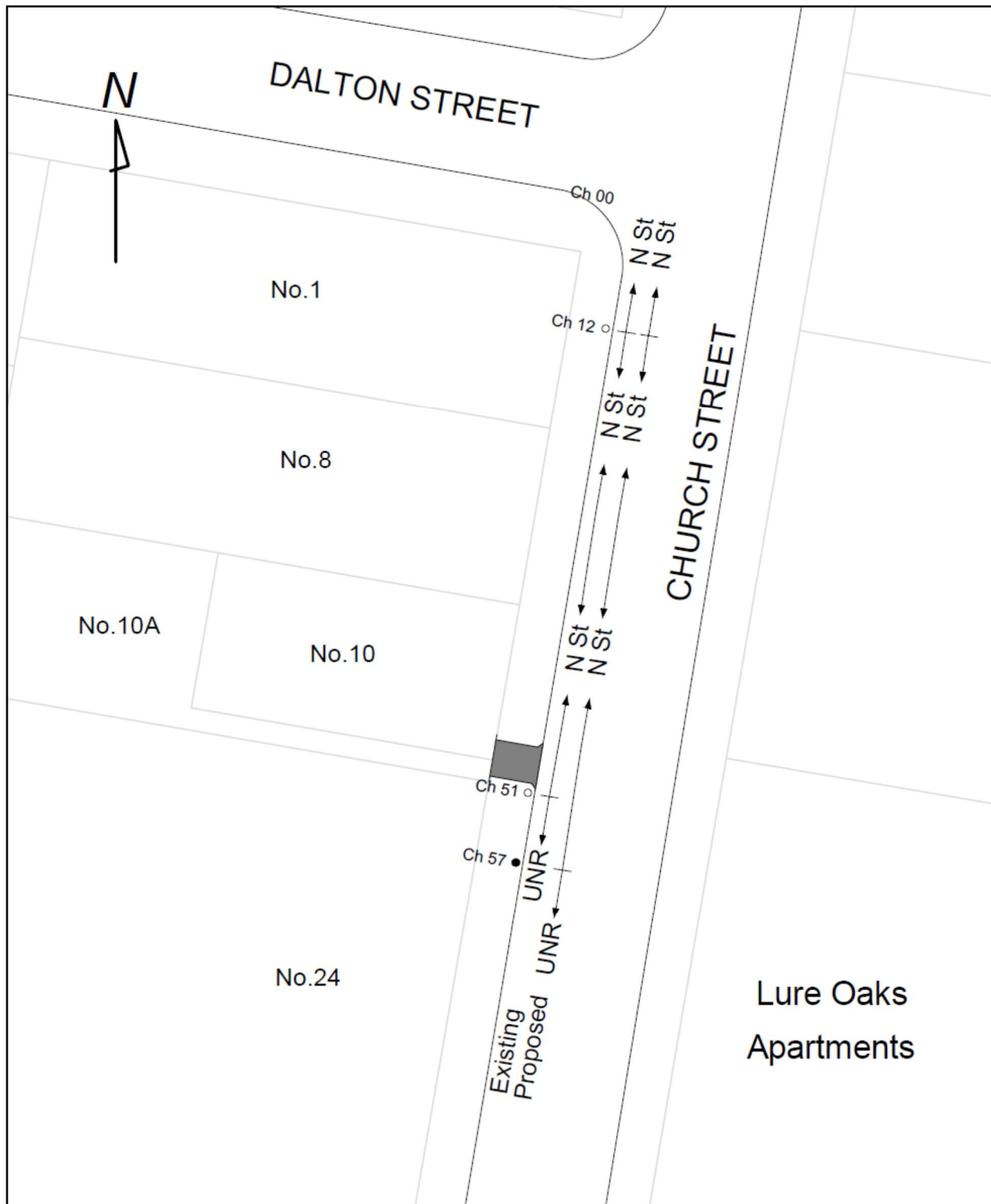

Legend

N St = No Stopping
UNR = Unrestricted parking

The meeting closed at 10.40am